

# EXTRUDED ALUMINUM CG SUSPENSION SYSTEM

## PART 1 – GENERAL

### 1.1 RELATED DOCUMENTS

A. Drawings and General Provisions of the Contract, including General and Supplementary Conditions and Division 1 Specification Sections apply to this Section.

### 1.2 SUMMARY

A. This section includes extruded aluminum grid system and perimeter as shown on the drawings.

### 1.3 REFERENCES

ASTM C635, Standard Specification for Metal Suspension Systems for Acoustical Tile and Lay-in Panel Ceilings.

ATSM C363, Recommended Practice for Installation for Metal Suspension for Acoustical Tile and Lay-in Panels

CISCA Ceiling Systems Installation Handbook.

### 2.2 SYSTEM Description

The ceiling Suspension System shall be CG (10, 15, or 20) series. Modular ceiling suspension system shall consist of 12' 0" main tees and/or 2' 0" nominal cross tees manufactured of extruded aluminum components by Gordon, Inc. All members shall be of standard 6063-T5 aluminum alloy. Each cross tee shall be factory fabricated for independent aluminum bend-tab clips on each end.

Main tees, cross tees, and wall angle shall be in our clear anodized aluminum finish.

All components shall be extruded aluminum, meeting all loading data. No roll formed aluminum grid will be allowed.

Main tees shall be joined together at each end by means of an independent aluminum bend-tab splice member.

Cross tees shall attach to main tees and other cross tees by means of an independent aluminum bend-tab clip which penetrates and slides through slots in the main tees and other cross tees.

All grid components have factory applied 3/32" x 3/8" (CG-10), 3/32" x 15/32" (CG-15), or 3/32" x 3/4" (CG-20) white closed-cell polyethylene gasket with adhesive on one side. Polyethylene gasket must pass fungus resistance test method 508.1 mill-std 810C flame resistance test FMYSS 302 with burn rate of 4" per minute.

The system shall comply with ASTM C-635 "Metal Suspension Systems for acoustical tile and lay-in panel ceilings", with intermediate duty (CG-10 & CG-15) and heavy duty (CG-20) designation.

### 2.3 MATERIALS

#### Extruded CG Suspension System

Extruded CG Suspension System shall consist of Main tees (Model# GG-CG15) in a clear anodized aluminum finish, Cross tees (Model# GG-CG15) in a clear anodized aluminum finish, Perimeter Wall Angle (Model# GG-CGWA15) in a clear anodized aluminum finish and all necessary clips and splices required for a complete system as required to meet local building codes.

Deflection of grid shall be limited to L/360 of span (1/8" maximum) when full dead load is applied.

Aluminum extrusion shall be 6063-T-5 alloys. (ASTM B221, ASTM B 221 M)

Materials shall be free from surface blemished where exposed to view in finished unit. Surfaces exhibiting pitting seam marks, roller marks. Stains, and discolorations, or other imperfections on finished units are not acceptable. All material shall be of the highest-grade commercial type.

## 2.4 FABRICATION

The suspension module will be (2' x 2' and 2' x 4') as shown in supplied plan-drawing.

All intersections between main tees and cross tees shall be butt cut and notched as required.

Perimeter shall be fabricated to match the system described in herein.

All components including accessories are available to meet codes such as seismic and loads such as light fixtures and air diffusers.

Hanger wires shall be #12 gauge galvanized without kinks and splices.

## 2.5 FINISHES

All suspension components visible shall be supplied with a satin clear anodized 200-R1 finish.

## PART 3 – EXECUTION

Tolerances:

1. Install ceiling system with maximum permissible deflection of L/360 of span maximum surface deviation of 1/8" in 10'-0" (no load applied) ASTM 635-92.

## 3.2 INSTALLATION

General: Comply with manufacturer's printed instructions, with governing regulations for Seismic Codes, and with the Ceiling & Interior Systems Construction Association standards applicable to work.

## 3.3 CLEANING

Clean all surfaces following installation. If necessary use only a mild soap or detergent solution such as TSP-90 or Ivory.

Replace units having scratches, abrasions, or other defects with unblemished panels or suspension.

Maintenance per manufacturer's finished maintenance instructions.

## 3.5 GENERAL RESPONSIBILITY

Variation from specification: Any variation from this specification resulting in additional cost to any other contractor or subcontractor on this project shall be the sole financial responsibility of the contractor for the work of this section.

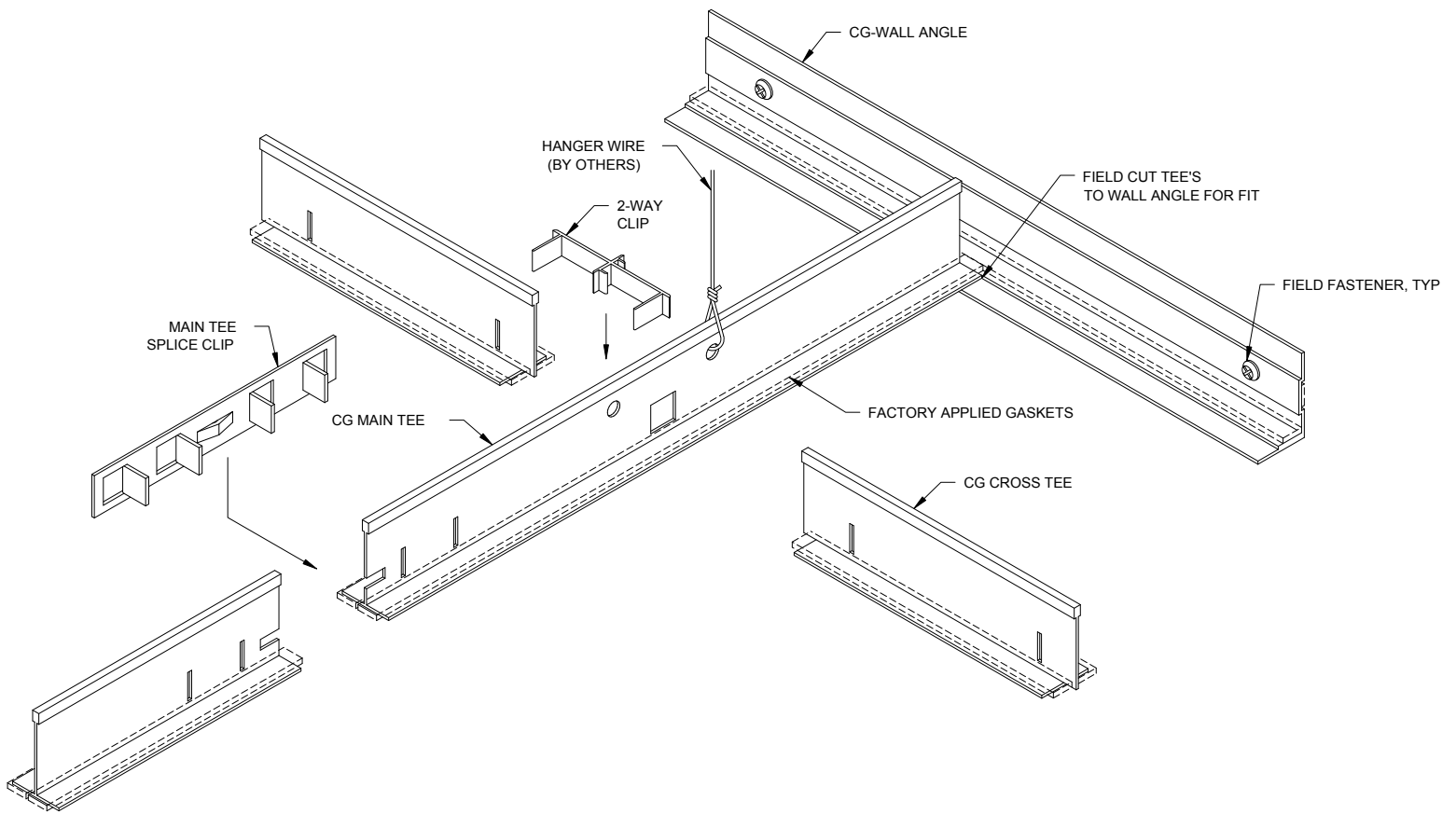

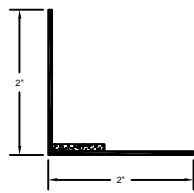

CG-20-WA

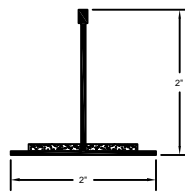

CG-20

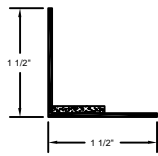

CG-15-WA

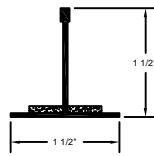

CG-15

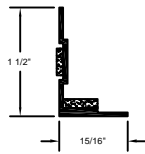

CG-WA-10

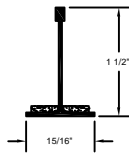

CG-10

# Cleanroom Wire Hung Grid System:

Gasketed RG System applications include semiconductor, microelectronic, aerospace, pharmaceutical, food processing, and hospital industries. The RG system differs from the CG system in that the 1-1/2" extruded aluminum face tee is designed with an upturned flange. Panels or filters contact the gasket to complete a seal prior to settling on the tee flange for a sharp architectural detail. RG provides an upgrade in appearance and performance over the more economical CG System.

## Finish

Standard finish is clear satin anodized aluminum, which is recommended for harsh environments. High performance powder coating and custom finishes are also available upon request. Powder coat finish is not a standard and is not recommended because of the notching required after the material is painted.

## Gasketing

The standard RG Series gasket is 1/4" x 1/2" closed cell PVC, gray in color, with small cells and a smooth surface. Custom gaskets are available with adhesive on one or both sides; polyvinyl, neoprene, polyethylene; anti-bacterial and flame retardant. For inquiries regarding custom gasket, contact the factory.

## Custom Panels

Custom .032 aluminum panels are manufactured in all sizes to allow for non-standard module sizes, fill-in perimeter panels, and sprinkler panels.

---

### RG Profile Detail

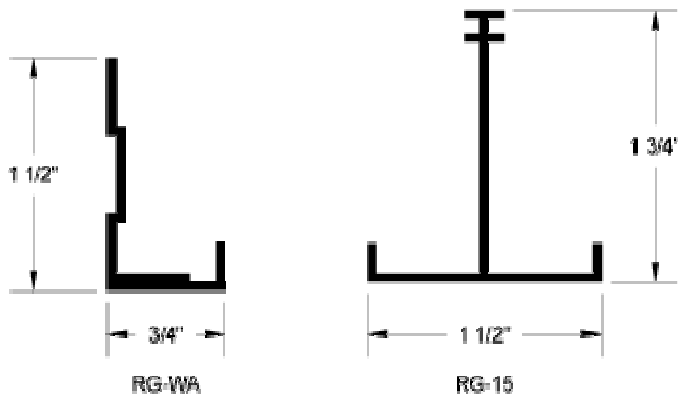

---

### RG Assembly Detail

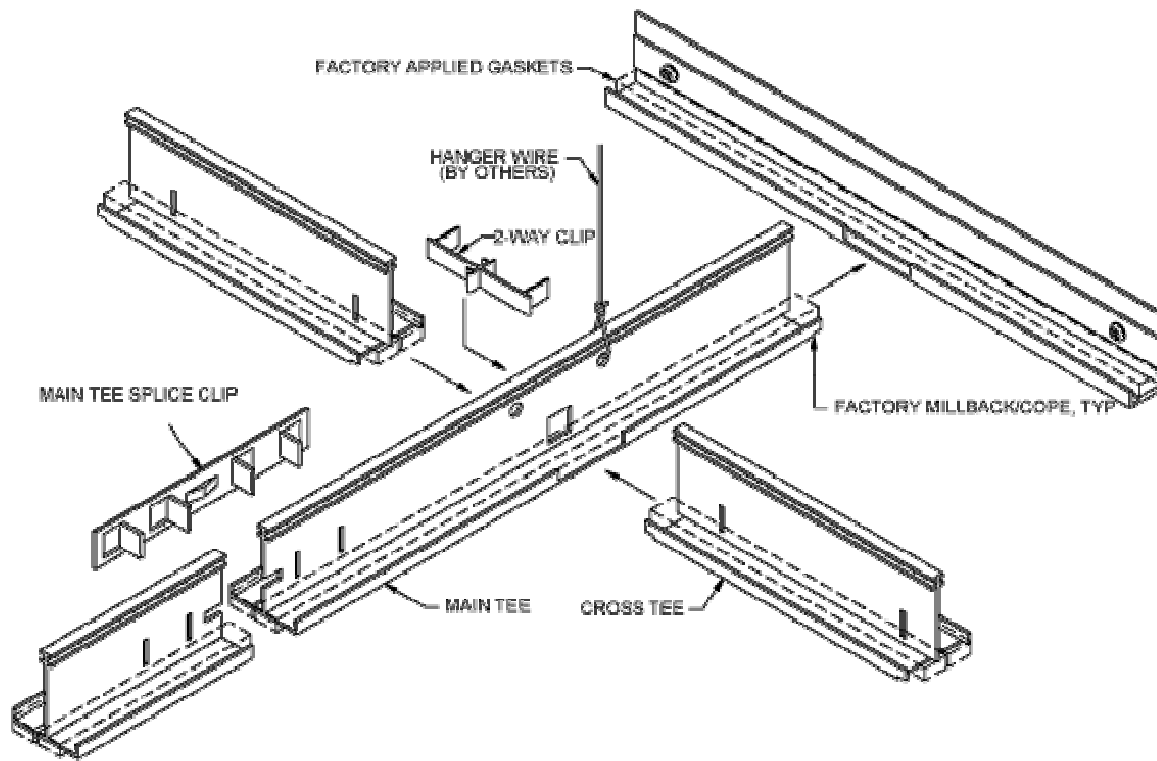

**TOP**  
Accessories

---

90° Angle Clip

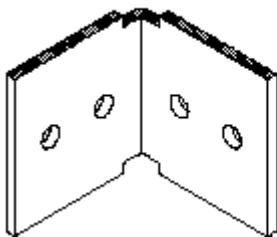

RG Hanger Clip

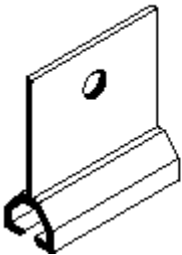

RGHC - Hold Down Clip

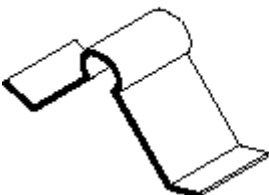

RG Accessories	
MTS-Main Tee Splice	1 per main tee
RG-2 Two Way Clips	1 per cross tee
RGHC Hold Down Clips	as needed for panel security / usually 4 per module
90° Angle Clip	tee attachment to wall angle
RG Sliding Hanger Clips	optional hanger clip slides along web of the tee allowing hanger wire attachment when special clearances for filters or fixtures are required